



**NOTICE OF CONSIDERATION OF  
SITE PLAN & SPECIAL LAND USE REQUEST**

**MEX RESTAURANT  
6675 TELEGRAPH ROAD  
(SIDWELL NO: 19-33-101-007)**

PLEASE TAKE NOTICE THAT a PUBLIC HEARING will be held by the Board of Trustees of the Charter Township of Bloomfield, Oakland County, Michigan on **MONDAY, JUNE 23, 2025, at 7:00 P.M.**, in the auditorium at the Bloomfield Township Hall, 4200 Telegraph Road, Bloomfield Hills, MI 48302. At the hearing, the Board will consider a site plan and special land use request for a patio expansion at MEX Restaurant, located at the northeast corner of Telegraph Road and Country Club Drive.



Comments regarding this request may be provided at the public hearing, submitted via email to [publiccomment@bloomfieldtwp.org](mailto:publiccomment@bloomfieldtwp.org) or by contacting the Planning Division at (248) 433-7795. Materials for the Board meeting will be made available to the public on Bloomfield Township's [Documents of Demand webpage](#) by the close of business on Thursday, June 19, 2025. Meetings are broadcasted live through [Bloomfield Community Television](#) on Comcast's channel 15 for residents of Bloomfield Township. The links and Quick Response ("QR") codes provided above can be utilized to view the meeting's materials and proceedings.

**MARTIN C. BROOK  
BLOOMFIELD TOWNSHIP CLERK**

NOTE: The Charter Township of Bloomfield will provide necessary, reasonable auxiliary aids and services at all meetings to individuals with disabilities. All such requests must be made at least five days prior to said meeting. Individuals with disabilities requiring auxiliary aids or services should contact Bloomfield Township by writing or calling the following: Letter • Bloomfield Township Clerk's Office, 4200 Telegraph Road, Bloomfield Hills, MI 48302. Email • [clerk@bloomfieldtwp.org](mailto:clerk@bloomfieldtwp.org) Phone • 248-433-7702.

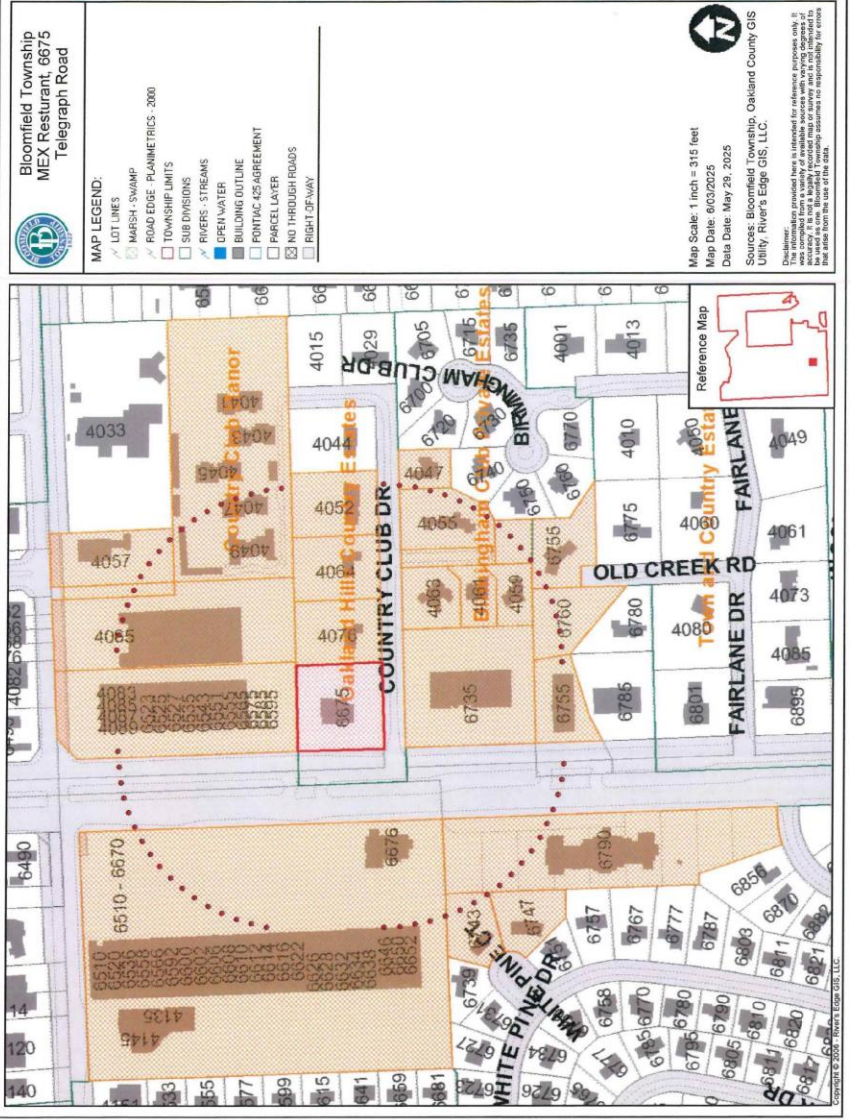

Bloomfield Township  
MEX Restaurant 6675  
Telegraph Road



MAP LEGEND:

- LOT LINES
- MARSH - SWAMP
- ROAD EDGE - PLANIMETRICS - 2000
- TOWNSHIP LIMITS
- SUB-DIVISIONS
- RIVERS - STREAMS
- OPEN WATER
- BUILDING OUTLINE
- PORTAGE AGREEMENT
- PARCEL LAYER
- NO THROUGH ROADS
- RIGHT OF WAY



Map Scale: 1 inch = 315 feet  
Map Date: 6/03/2025  
Data Date: May 29, 2025  
Sources: Bloomfield Township, Oakland County GIS  
Utility, River's Edge GIS, LLC

Disclaimer:  
The information provided here is intended for reference purposes only. It is not a legally recorded map or survey and is not intended to be used for legal purposes. The information is provided as a service and is not a warranty. The user assumes all responsibility for errors and omissions.